

STUDIO RENTAL RATES [DESCRIPTION / SIZE]	OFF PEAK RATE • MON TO FRI 12 to 6 pm	PEAK RATE • MON TO FRI 6 to 11 pm • SAT 9 am to 6 pm • SUN 10 am to 7 pm	SPECIAL STAFF ARRANGEMENTS • MON TO SUN HOURS NOT SPECIFIED UNDER PEAK & OFF PEAK
Studio 1 [Glass] 990 sqft (Triangle-ish) 12.6m x 13.3m x 9m x 4m	\$ 70.00	\$ 80.00	\$ 120.00
Studio 2 [Ballet] 1,050 sqft (Rectangle) 13.3m x 7.8m Dance Mat, Ballet Barres	\$ 90.00	\$ 100.00	\$ 150.00
Studio 3 [Party] 1,300 sqft (Rectangle) 15m x 8m DJ sound system setup Mood lighting setup	\$ 90.00	\$ 100.00	\$ 150.00
Studio 4 [Jazz] 1,250 sqft (Rectangle) 15m x 7m Dance Mat, Ballet Barres	\$ 90.00	\$ 100.00	\$ 150.00
Studio 5 [Tap] 670 sqft (Square-ish) 9m x 7m	\$ 40.00	\$ 50.00	\$ 75.00
Studio 6 [Private] 250 sqft (Rectangle) 6m x 4m	\$ 30.00	\$ 40.00	\$ 60.00

1. All rates are quoted on a per hour basis.
2. For rentals starting half hour before peak, the rental will be calculated based on the peak rate.
2. Rates are applicable to usage of studios for rehearsals only.
3. Rates are not applicable to usage of studios for conducting classes.
4. For studio rental rates to conduct classes, please contact Fen Tonge at fen@swingapore.com.

Last updated: **1 Oct 2011**

JITTERBUGS SWINGAPORE

2 Handy Road
#B1-08 The Cathay
Singapore 229233
T.65.6887.0383 | F.65.6887.0538
dance@swingapore.com
www.swingapore.com



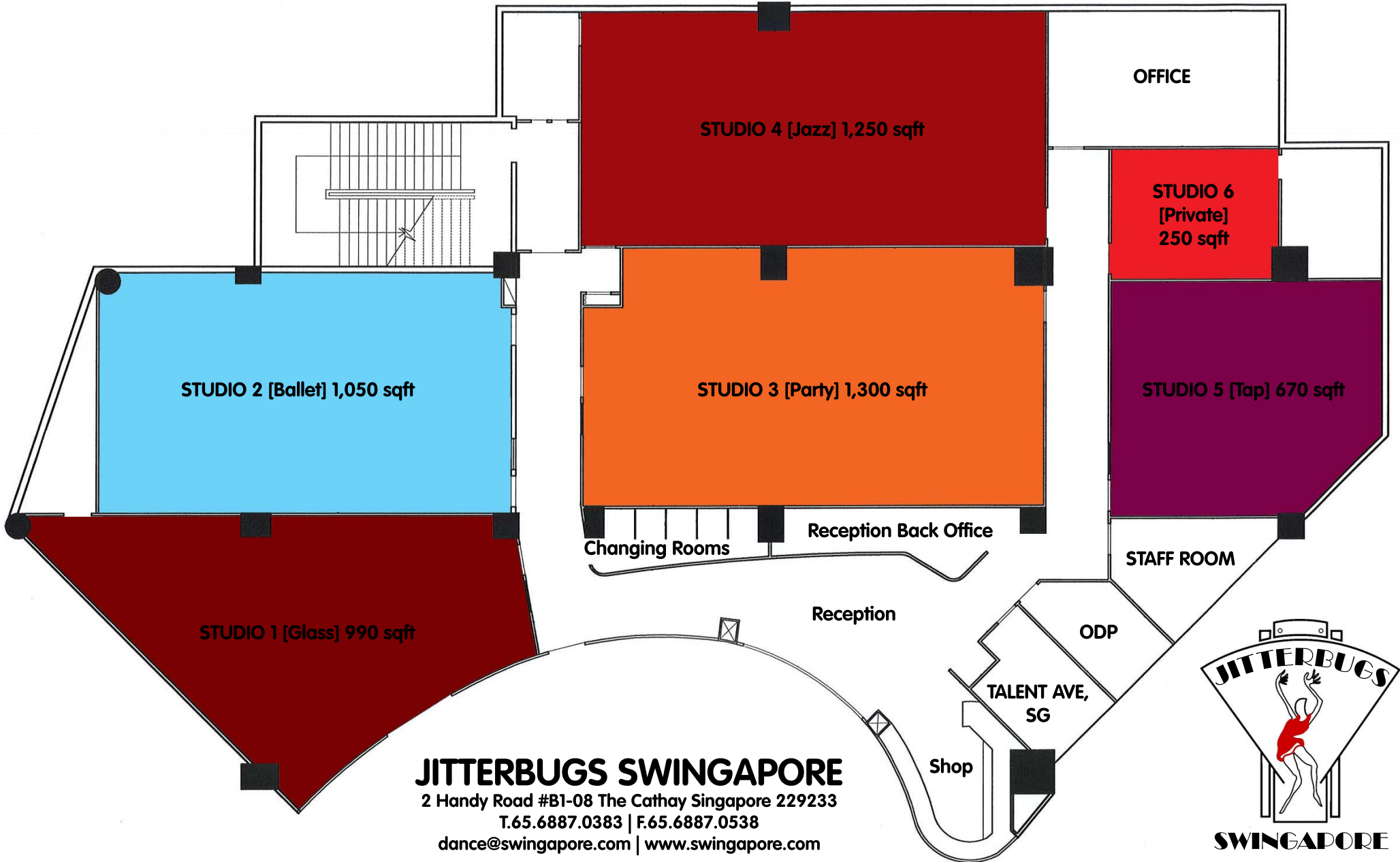

JITTERBUGS SWINGAPORE
 2 Handy Road #B1-08 The Cathay Singapore 229233
 T.65.6887.0383 | F.65.6887.0538
 dance@swingapore.com | www.swingapore.com

